

MODULAR

Clip connector, spring steel with shoulder head screw

MODULAR 4031

Art.-No. Z4031



Pass-thru clip

MODULAR 4032

Art.-No. Z4032



Easy to release clip



Hard to release clip

Art.-No. Z4032C

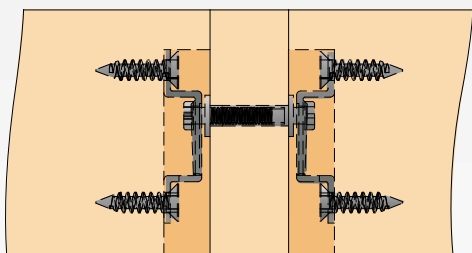
Drill and depth-jig
for connector groove

MODULAR double side connection for vertical panels

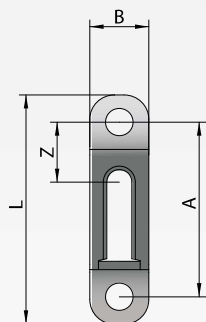

Continuous groove

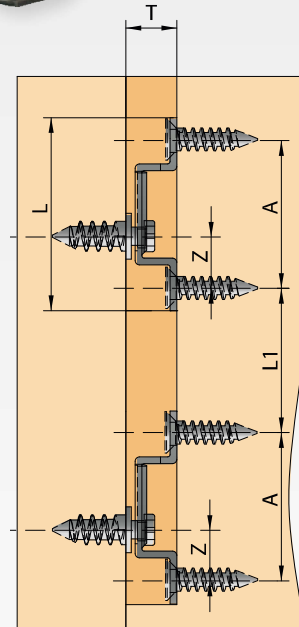
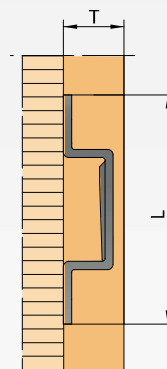

MODULAR	4031, 4032, 4035
Routing depth T:	11 mm
Routing length L:	≥ 42 mm
Routing width B:	11 mm
Center distance Z:	11 mm
Panel thickness from:	16 mm
Hole-line A:	32 mm

MODULAR clip, suitable with the 32 mm
system boring

Totally concealed installation

Application: Flat pack, RTA cabinets, case goods, and furniture.**Benefits:** Concealed, self-tightening connector for 32 mm system, demountable, for timber and steel.**Installation:** Make groove with spindle moulder, plunge router, CNC equipment.**Installation:** Pre-drill with drill-jig and install clips with PH- or CS-screws $\varnothing = 4,5$ mm (length depending on application).
Shoulder head screw engages with the clip when sliding them into each other.**Suitable materials:** For all solid wood, wood based panels and plastic materials from 16 mm thickness up.**Accessories:** Drill and depth-jig | Art.-No. Z4032C

MODULAR - shoulder head screw

Shoulder head screws

MODULAR 2055

Art.-No. Z2055



Thread length: 13 mm

MODULAR 2155

Art.-No. Z2155



16 mm

MODULAR 2055

Art.-No. Z5068



32 mm

Double side connection

Shoulder head screws M4

MODULAR 2069

Art.-No. Z2069



15 mm

MODULAR 2066

Art.-No. Z2066

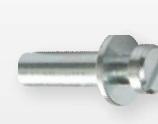

16 mm